

Economy Line

High Number Of Travels Thanks To Frequency Control



Products

The Bucher Hydraulics range

Bucher Hydraulics offers a wide range of hydraulic lift components.

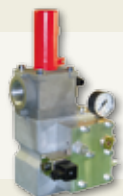

Electronically controlled lift valves (LRV)

Bucher Hydraulics lift control valves provide unsurpassed ride comfort, irrespective of load and temperature.

All lift control valves are factory preset to the installation-specific parameters. This reduces the on-site installation time to the minimum.



Power units

Compact Line: the good-value package solution with the innovative synthetic tank and the C-LRV electronically controlled lift valve.

Comfort Line: the standard power unit with the LRV-1 electronically controlled lift valve offers unlimited application possibilities and numerous options.

Economy Line: the high-performance, economical, and low-noise drive solution with the VF-LRV electronically controlled lift valve reduces energy consumption by up to 80% in comparison with mechanically controlled hydraulic lift installations.

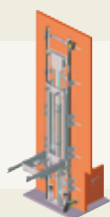

Frame kits

Pluto: The range of side-ram frame kits is suited for hydraulic passenger and goods/passenger lifts with payloads up to 1,600 kg.

Jupiter: The range of tandem-frame kits is suited for hydraulic goods/passenger lifts with payloads up to 6,000 kg.

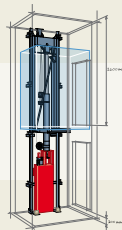

MRL-drive systems (machine room-less)

BERIPAC™: the system offers maximum travel performance with minimum energy consumption.

Tiger: the best system for the optimum shaft utilisation.



Modernisation

MULTIKIT: the route to perfect modernisation of a hydraulic lift drive, without time-consuming and costly replacement of the lift controller.



Cylinders

Versatile, robust and reliable.

Ideal for modernisation and conversions

Saturn ALPHA



The perfect solution for frequently used lift installations in public buildings such as airports, train stations and shopping centres.

High travel performance

Up to 120 travels per hour are possible without oil cooler and costly machine-room ventilation.

Low-noise technology

As much as 10 dBA quieter in the machine room.

Save energy

Energy savings of up to 60% can be achieved.

Short and consistent travel times, irrespective of load and temperature

Irrespective of load and temperature, this hydraulic drive ensures a high degree of stopping accuracy, short and consistent slow-speed travels, and delay-free starts – with unvarying, unsurpassed ride comfort.

Inexpensive installation, operation and maintenance

The effort and costs of installing a cooling facility are eliminated. Hydraulic components suffer less wear thanks to the lower oil temperatures.

Existing installations with overheating problems can easily be converted

Before	After
<p>Power unit with oil cooling, and costly machine-room ventilation</p>	<p>Power unit with frequency control, 120 travels/hour without an oil cooler and up to 60% energy savings *for modernisation without changing the controller</p>

Typical application areas

Saturn ALPHA	Valve	Payload kg	Cabin weight kg	Travel height m	Speed m/s	System
UDA 230	VF-LRV 350	630	700	up to 17	1.00	Rucksack 2:1
UD 350	VF-LRV 350	1000	1500	up to 17	1.00	Rucksack 2:1
UD 500	VF-LRV 700	1500	2000	up to 20	1.00	Rucksack 2:1
UC 750	VF-LRV 700	3000	3000	up to 20	0.63	Tandem 2:1

Unmatched hydraulic efficiency

Economy Line

The powerful, economical and low-noise drive solutions with reduced energy consumption of as much as 80 %.

Power units in the Economy Line are available in two versions

- Saturn ALPHA: the perfect solution for high travel performance.
- Orion ALPHA: the solution with hydraulic counterweight for reduced power input.

Variable-frequency technology

Your investment in VVVF technology easily pays for itself.

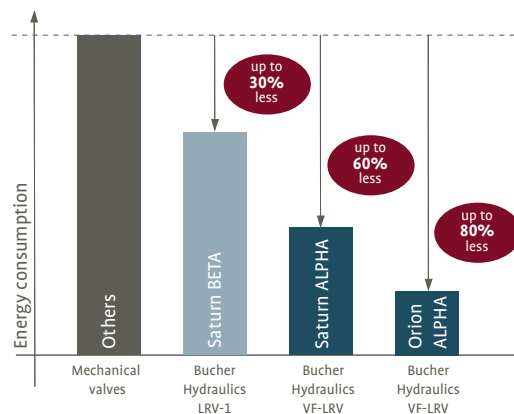

We will be pleased to calculate the possible energy- and cost-savings for an actual project!

Upgrading of existing hydraulic lift installations

With the MULTIKIT conversion package, an existing hydraulic lift can be modernised without having to replace the controller.

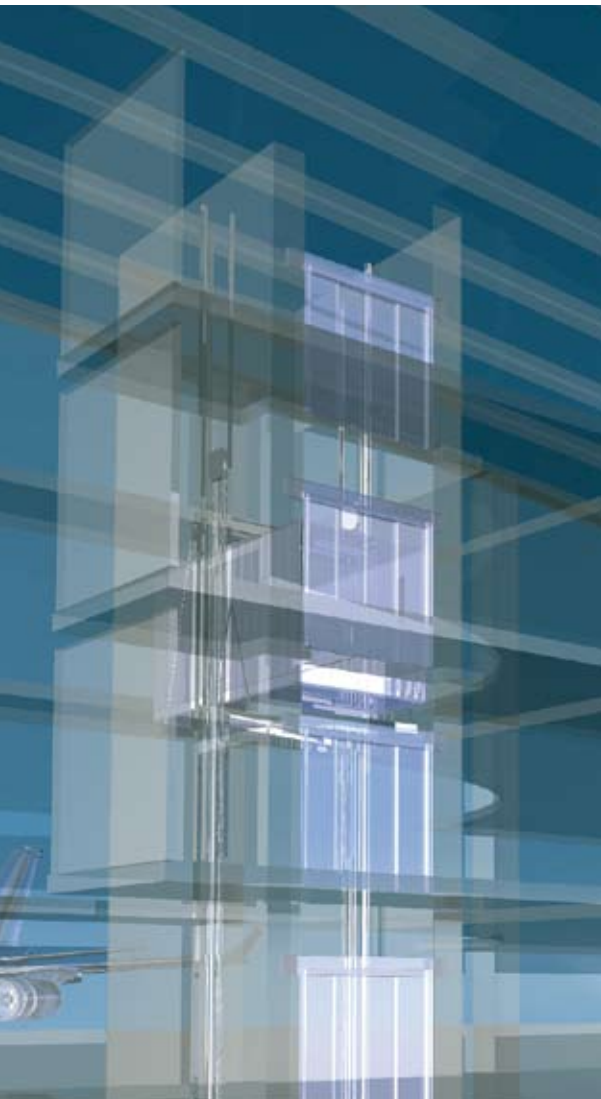

Delta Controller DELCON

The VF-LRV electronically controlled lift valve is complemented by the latest digital electronic technology.

- Improved travel performance
- Travel curves displayed on PC
- Demand/feedback monitoring (SIU1) and speed monitoring in the door zone (SIU4) are possible
- Fault logging
- Optional adjustments and fault diagnosis via Handterminal or „Windelta 32“ PC software

Frequency control and hydraulic counterweight

Orion ALPHA



Instead of a counterweight, hydraulic pressure accumulators are installed.

During every UP travel, these release their stored pressure once again, thus relieving the load on the electrical drive.

Maximum travel performance

The high efficiency means that, maximum travel performance can be attained with the existing electrical supply rating.

Up to 120 travels per hour are possible without oil cooler and costly machine-room ventilation.

Low-noise technology

As much as 10 dBA quieter in the machine room.

Save energy costs and reduce standing charges

Up to 80% energy saving and 40% lower connection power possible.

Short and consistent travel times, irrespective of load and temperature

Irrespective of load and temperature, this hydraulic drive ensures a high degree of stopping accuracy, short and consistent slow-speed travels, and delay-free starts – with unvarying, unsurpassed ride comfort.

Inexpensive installation, operation and maintenance

The effort and costs of installing a cooling facility are eliminated. In addition, when a hydraulic counterweight in the form of a pressure accumulator is installed, it is more compact than a conventional counterweight and also safer, particularly in earthquake zones.

Hydraulic components suffer less wear thanks to the lower oil temperatures.

Typical application areas

Orion ALPHA	Valve	Payload kg	Cabin weight kg	Travel height m	Speed m/s	System
UD 450A	VF-LRV 350	500	750	up to 20	0.63	Side-ram 2:1
UD 450A	VF-LRV 350	2000	2500	up to 15	0.63	Tandem 2:1

Bucher Hydraulics AG

Industriestrasse 15

CH-6345 Neuheim

Phone +41 41 757 03 33

Fax +41 41 757 03 17

elevator@bucherhydraulics.com

www.bucherhydraulics.com